

## L1082 Drop Cable

---

### Structure

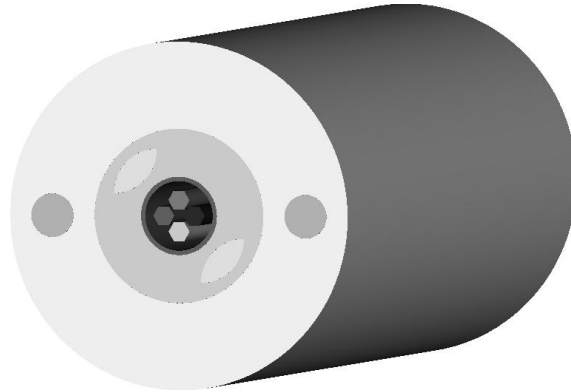

### Description

This indoor cable family is suitable for fast installations and designed for a long term application in the field. The cable consists of up to four fibers and consists of an inner tube, which is easily strippable by bare fingers and low force application. FRP elements in outer LSZH sheath and Kevlar or glass yarn provide excellent mechanical performance of this products.

### Features

- Fast and easy indoor installations
- Inner tube can be easily stripped with bare hands. Thin walled elastomer tubing.
- Easy to tear the sheath in the longitudinal direction using all the fibers, by pulling gently firstly on the sheath, and secondly on the fibers previously released from the sheath over a few centimeters
- Strong mechanical properties for harsh environment. High tensile and crush strength.

### Applications

- Mainly deployed in FTTH
- Long life time applications with easy installation

# L1082 Drop Cable

## Specifications and Performance

Fibers		1	2	3	4
Outer Diameter [mm]		4.0	4.0	4.0	4.0
Weight [kg/km]		25	25	25	25
Allowed tension [N]	Service	400	400	400	400
	Long Term	2000	2000	2000	2000
Allowed crush [N/100mm]	Short Term	2500	2500	2500	2500
	Service (static)	10 d	10 d	10 d	20 d
Min. Bend radius [mm]	Installation (dynamic)	10 d	10 d	10 d	10 d
	Radius [mm]	30	30	30	30
Temperature	Installation	-5 °C to +40 °C			
	Service	-30 °C to +70 °C			
	Storage	-40 °C to +70 °C			

## Standards

Temperature	IEC 60794-1-2 F1
Tensile performance	IEC 60794-1-2 E1
Crush resistance	IEC 60794-1-2 E3
Kink resistance	IEC 60794-1-2-E10
Impact	IEC 60794-1-2 E4
Repeated bending	IEC 60794-1-2 E6
Torsion	IEC 60794-1-2 E7
Water Penetration	IEC 60794-1-2 F5B
Thermal ageing	ST/FT/RD/RESA/12/02/24 Paragraph 3.2.2 FT/RD/WTC/14/03/87
Fire Resistance	C2
UV radiation	ST/FT/RD/RESA/12/02/24 Paragraph 3.2.4 FT/RD/WTC/14/03/87
Chemical Behavior	ST/FT/RD/RESA/12/02/24 Paragraph 3.2.5 FT/RD/WTC/14/03/87

## Options

Standard delivery length	500/1000/2000/4000 m Other lengths on request
--------------------------	--